

L-7676CPBC-H-04

BLUE

Features

- SUPER FLUX OUTPUT.
- DESIGN FOR HIGH CURRENT OPERATION.
- OUTSTANDING MATERIAL EFFICIENCY.
- RELIABLE AND RUGGED.

Description

The source color devices are made with InGaN on SiC Light Emitting Diode.

Package Dimensions

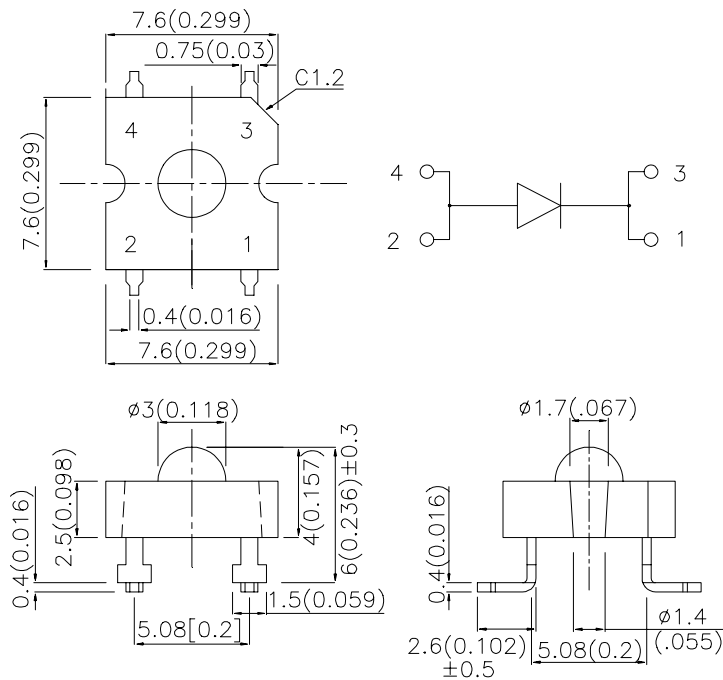

Notes:

1. All dimensions are in millimeters (inches).
2. Tolerance is ±0.25(0.01") unless otherwise noted.
3. Lead spacing is measured where the lead emerge package.
4. Specifications are subject to change without notice.

Selection Guide

| Part No. | Dice | Lens Type | Iv (mcd) @ 20 mA *70mA | | Viewing Angle |
|-----------------|--------------|-------------|---------------------------|-------|------------------|
| | | | Min. | Typ. | 2θ1/2 |
| L-7676CPBC-H-04 | BLUE (InGaN) | WATER CLEAR | 380 | 800 | 70° |
| | | | *1200 | *1900 | 70° |

Notes:

1. θ1/2 is the angle from optical centerline where the luminous intensity is 1/2 the optical centerline value.
2. * Luminous intensity with asterisk is measured at 70mA.
3. Drive current between 10mA and 30mA are recommended for long term performance.
4. Operation at current below 10mA is not recommended.

Electrical / Optical Characteristics at T_A=25°C

| Symbol | Parameter | Device | Typ. | Max. | Units | Test Conditions |
|-------------------|--------------------------|--------|------|------|-------|---------------------------|
| λ _{peak} | Peak Wavelength | Blue | 467 | | nm | I _F =20mA |
| λ _D | Dominate Wavelength | Blue | 470 | | nm | I _F =20mA |
| Δλ _{1/2} | Spectral Line Half-width | Blue | 30 | | nm | I _F =20mA |
| C | Capacitance | Blue | 110 | | pF | V _F =0V;f=1MHz |
| V _F | Forward Voltage | Blue | 3.7 | 4.3 | V | I _F =20mA |
| I _R | Reverse Current | Blue | | 10 | uA | V _R = 5V |

Absolute Maximum Ratings at T_A=25°C

| Parameter | Blue | Units |
|-------------------------------|---------------------|-------|
| Power dissipation | 108 | mW |
| DC Forward Current | 30 | mA |
| Peak Forward Current [1] | 100 | mA |
| Reverse Voltage | 5 | V |
| Operating/Storage Temperature | -40°C To +85°C | |
| Lead Solder Temperature [2] | 260°C For 5 Seconds | |

Notes:

1. 1/10 Duty Cycle, 0.1ms Pulse Width.
2. 2mm below package base.

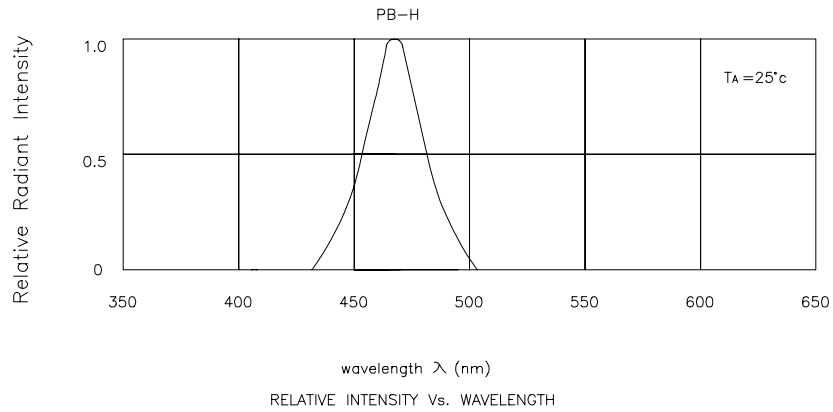

Blue

L-7676CPBC-H-04

