

THIS DOCUMENT IS THE PROPERTY OF
KEYSTONE ELECTRONICS CORP. AND
SHALL NOT BE REPRODUCED, DISTRIBUTED
OR USED AS A BASIS FOR MANUFACTURE
WITHOUT PRIOR WRITTEN PERMISSION
FROM KEYSTONE ELECTRONICS CORP.

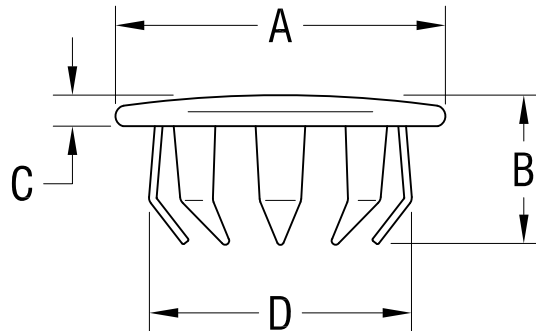

PART NO.	NO. OF PRONGS	$\pm .005$ [± 0.15] 'A' DIM.	$\pm .015$ [± 0.38] 'B' DIM.	$\pm .005$ [± 0.15] 'C' DIM.	$\pm .010$ [± 0.25] 'D' DIM.
7600	6	.406 [10.3]	.234 [5.9]	.062 [1.57]	.260 [6.6]
7601	6	.437 [11.1]	.250 [6.4]	.062 [1.57]	.330 [8.4]
7602	6	.500 [12.7]	.234 [5.9]	.062 [1.57]	.390 [9.9]
7603	8	.656 [16.7]	.281 [7.1]	.078 [1.98]	.520 [13.2]
7604	8	.812 [20.6]	.296 [7.5]	.078 [1.98]	.635 [16.1]
7605	12	.921 [23.4]	.296 [7.5]	.078 [1.98]	.760 [19.3]
7606	12	1.062 [27.0]	.296 [7.5]	.062 [1.57]	.890 [22.6]
7607	12	1.140 [29.0]	.328 [8.3]	.093 [2.36]	1.020 [25.9]
7608	12	1.312 [33.3]	.343 [8.7]	.093 [2.36]	1.150 [29.2]
7609	12	1.437 [36.5]	.343 [8.7]	.093 [2.36]	1.281 [32.5]
7610	12	1.562 [39.7]	.406 [10.3]	.078 [1.98]	1.395 [35.4]

KEYSTONE ELECTRONICS CORP.

ASTORIA, N.Y. 11105-2017

PART NAME

STEEL HOLE PLUG

MATERIAL

STEEL

FINISH

NICKEL PLATE

DRN BY

BOONE

DATE

11.22.06

APP'D

LN

SCALE

NONE

TOLERANCES

INCH [MM]

DECIMAL $\pm .005$ [± 0.15]

ANGULAR $\pm 1^\circ$

UNLESS OTHERWISE SPECIFIED

CODE

C/M

DWG NO.

7600-7610

DATE

DESCRIPTION

REV.