

BATTERY CONTACTS

Designers' Choice



"A" • "AA" • "AAA" • "N" SIZE PC BUTTON & SPRING CONTACTS



MATERIAL: Frame: .015 Steel, Tin Plate

- Ideal contacts for "A" • "AA" • "AAA" • "N" size batteries.
- Space saving design installs directly onto the PC board
- Ideal for self-contained battery compartments
- Contacts available for .062 and .093 thick PC boards
- Reliable spring and/or button assures low contact resistance



MATERIAL: Frame: .015 Steel, Tin Plate
Uses Cat. No. 211 Spring Contact

(+) Positive Button

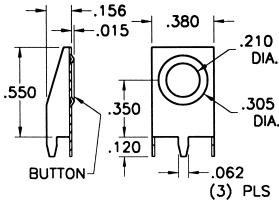

Mounting Detail

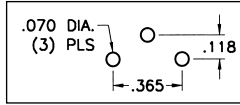

CAT. NO. 595 - For "A"

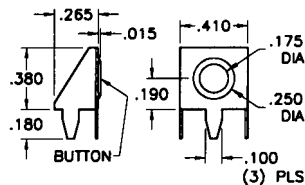

Mounting Detail

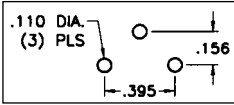

CAT. NO. 637 - For "AA" • "AAA" • "N"

(-) Negative Spring

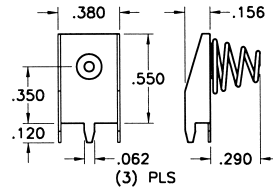

Mounting Detail

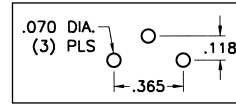

CAT. NO. 628 - For "A"

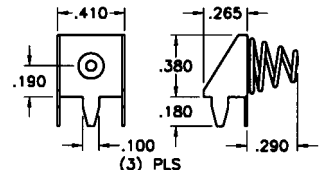

Mounting Detail

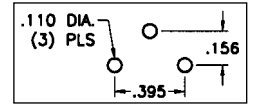

CAT. NO. 629 - For "AA" • "AAA" • "N"

SURFACE MOUNT BATTERY CONTACTS

For "AAA" • "AAAA"

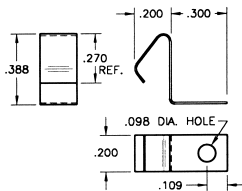

CAT. NO. 5230
CAT. NO. 5230TR



Tape and Reel Spec's: 24mm wide; 12mm pitch;
13 inch reel (400 pieces per reel)

For "A" • "AA" • "9V"

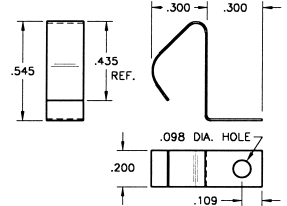

Tape and Reel Spec's: 32mm wide; 12mm pitch;
13 inch reel (400 pieces per reel)



CAT. NO. 5231
CAT. NO. 5231TR

• ECONOMICAL • SPACE SAVING

PC BATTERY CONTACTS

• Ideal for self-contained battery compartments
• Contact us for modifications and custom design

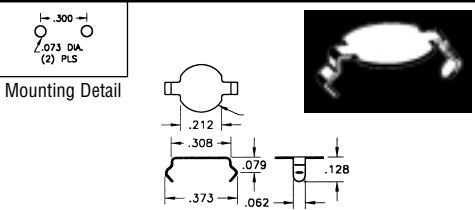

CAT. NO. 2990 .008 Thick, Phosphor Bronze, Nickel Plate

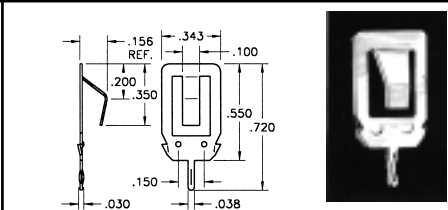

CAT. NO. 108-2 .012 Thick, Spring Steel, Nickel Plate

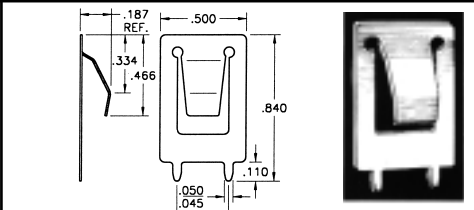

CAT. NO. 109-2 .012 Thick, Spring Steel, Nickel Plate

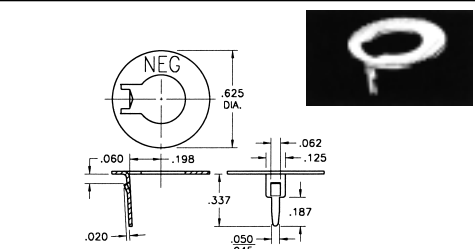

CAT. NO. 105-3 .020 Thick, Spring Steel, Nickel Plate

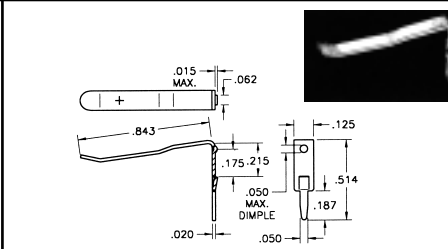

CAT. NO. 105-2 .020 Thick, Spring Steel, Nickel Plate

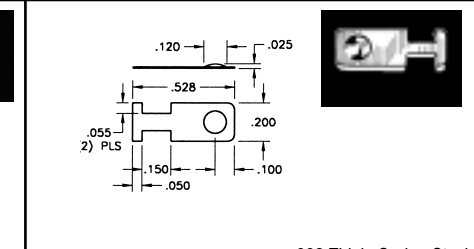

CAT. NO. 230-1 .008 Thick, Spring Steel, Nickel Plate

