

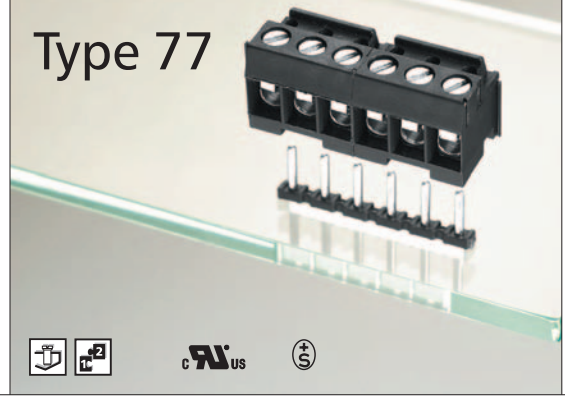

## Type 07



## Type 77



### Headers

to **Type 07** and **Type 77**

**Type 17/27** page 120

**Type 41** page 122

**Type 39** page 128

### Accessories

for **Type 07**

**Coding pin**

710121 short

720122 long page 164

**Coding set**

716846

page 165

**Latching flange**

710084 right

710085 left page 161

for **Type 77**

**Coding pin**

710121 short

710122 long page 164

**Coding set**

716846

page 165

**Mounting flange**

750150 right

750151 left page 162

### Note for wire range

Additional wire sizes and/or combinations of same size wires as follows:

**Type 07** and **Type 77**

#(1) Wire range extended to No. 30 AWG for factory-wiring.

+ Two same size wires  
No. 22 - 16 AWG Cu Sol/Str for field-wiring;  
No. 30 - 16 AWG Cu Sol/Str factory-wiring.

### Description Type 07

Screw type terminal block, pluggable, centerline 5 mm / 0.197 inches, wire entry perpendicular to plug direction, wire protector, female contact

### Technical Data Type 07

**US** V / A / AWG 300 / 15 / 22 - 12 #(1), + (see note)  
Screw torque max. 7 lbs.-in

0.08 - 2.5 mm<sup>2</sup> 125 V / 2.5 kV / 3 / 10 A  
Insulation co-ordination according to IEC 664-1  
Clearance and creepage distance ≥ 2.3 mm  
Screw torque max. 0.5 Nm

Wire diameter single wire 0.3 - 1.8 mm  
Wire strip length 6 mm / 0.236 in.  
Contact resistance from the termination point via header to the pc board ≤ 5 mΩ per pole  
Pole size 2 to 24  
Color black

### Description Type 77

Screw type terminal block, pluggable, centerline 5 mm / 0.197 inches, wire entry perpendicular to plug direction, wire protector, modular, female contact

### Technical Data Type 77

**US** V / A / AWG 300 / 15 / 22 - 14 #(1), + (see note)  
Screw torque max. 7 lbs.-in

0.08 - 2.5 mm<sup>2</sup> 125 V / 2.5 kV / 3 / 10 A  
Insulation co-ordination according to IEC 664-1  
Clearance and creepage distance ≥ 2.3 mm  
Screw torque max. 0.5 Nm

Wire diameter single wire 0.3 - 1.8 mm  
Wire strip length 6 mm / 0.236 in.  
Contact resistance from the termination point via header to the pc board ≤ 5 mΩ per pole  
Pole size 2, 3  
Color black

Dimensions in mm

1 mm = 0.0394 in.

Dimensions in mm

1 mm = 0.0394 in.

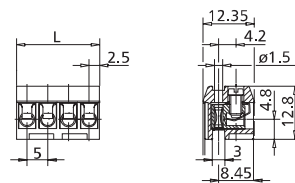

L = (pole size - 1) x centerline + 5 mm / 0.197 in.

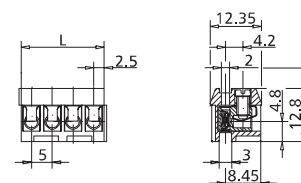

L = (pole size - 1) x centerline + 5 mm / 0.197 in.

### Part numbers (P/N)

#### Type 07

centerline 5 mm / 0.197 inches

P/N 310071



Complete the part number by adding the pole size.

	02	03	04	05	06	07	08
09	10	11	12	13	14	15	16
17	18	19	20	21	22	23	24

#### Type 07

centerline 10.16 mm / 0.400 inches

P/N 310072



	02	03	04	05	06	07	08
09	10	11	12				

### Part numbers (P/N)

#### Type 77

centerline 5 mm / 0.197 inches

P/N 310771



Complete the part number by adding the pole size.

	02	03					

Standard pole sizes

Available on demand.  
Minimum order quantity 5000 poles per item.

Standard pole sizes

Available on demand.  
Minimum order quantity 5000 poles per item.