

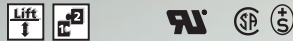

Type 97

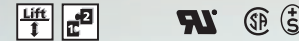

Type 73



Note for wire range

Additional wire sizes and/or combinations of same size wires as follows:

Type 97 and Type 73

- ## 2 No. 22 - 16 AWG (field-wiring);
- 2 No. 30 - 16 AWG or 1 No. 30 - 12 AWG (factory-wiring)

Description Type 97

Screw type terminal block, solderable, centerline 5.08 mm / 0.200 inches, horizontal wire entry, lift system, modular, two-tier terminal block

Technical Data Type 97

- V / A / AWG 300 / 20 / 22 - 12 ## (see note)
- V / A / AWG 300 / 20 / 22 - 12 ## (see note)
- Screw torque max. 6 lbs.-in
- 0.08 - 2.5 mm² 250 V / 4 kV / 3 / 16 A
- Insulation co-ordination according to IEC 664-1
- Clearance and creepage distance ≥ 4 mm
- Screw torque max. 0.5 Nm

Wire diameter	single wire 0.3 - 2.7 mm
Wire strip length	8 mm / 0.315 in.
Solder pin	0.8 x 1 mm 0.031 x 0.039 in. recommended pc board hole dia. 1.4 mm / 0.055 in.
Solder pin length front	4 mm / 0.157 in.
Solder pin length back	5 mm / 0.197 in.
Pole size	4, 6
Color	black

Dimensions in mm 1 mm = 0.0394 in.

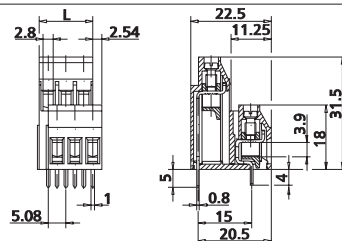

L = (pole size - 1) x centerline + 5.08 mm / 0.200 in.

Description Type 73

Screw type terminal block, solderable, centerline 5.08 mm / 0.200 inches, horizontal wire entry, lift system, modular

Technical Data Type 73

- V / A / AWG 300 / 20 / 22 - 12 ## (see note)
- V / A / AWG 300 / 20 / 22 - 12 ## (see note)
- Screw torque max. 6 lbs.-in
- 0.08 - 2.5 mm² 250 V / 4 kV / 3 / 16 A
- Insulation co-ordination according to IEC 664-1
- Clearance and creepage distance ≥ 4 mm
- Screw torque max. 0.5 Nm

Wire diameter	single wire 0.3 - 2.7 mm
Wire strip length	8 mm / 0.315 in.
Solder pin	0.8 x 1 mm 0.031 x 0.039 in. recommended pc board hole dia. 1.4 mm / 0.055 in.
Solder pin length	4.1 mm / 0.161 in.
Pole size	2, 3
Color	black

Dimensions in mm 1 mm = 0.0394 in.

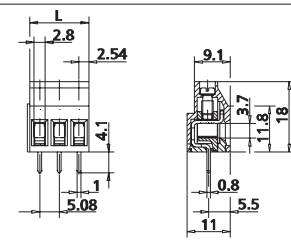

L = (pole size - 1) x centerline + 5.08 mm / 0.200 in.

Part numbers (P/N)

Type 97

centerline 5.08 mm / 0.200 inches

P/N 310971

Complete the part number by adding the pole size.

	04	06							
--	----	----	--	--	--	--	--	--	--

Part numbers (P/N)

Type 73

centerline 5.08 mm / 0.200 inches

P/N 310731

Complete the part number by adding the pole size.

	02	03							
--	----	----	--	--	--	--	--	--	--

- Standard pole sizes
- Available on demand. Minimum order quantity 5000 poles per item.

- Standard pole sizes
- Available on demand. Minimum order quantity 5000 poles per item.