



## Distanzhülsen Messing

### Material:

Messing                      CuZn39Pb3                      Werkstoff-Nr. 2.0401 / CW614N

### Oberflächenbehandlung nach DIN EN ISO 4042 (ehem. DIN 267-9)

- vernickelt 3 µm (E1E)

### Fertigungstoleranzen

Allgemeintoleranzen nach DIN ISO 2768-1:1999-11 (ehem. DIN 7168-1)  
Toleranzklasse m (mittel)

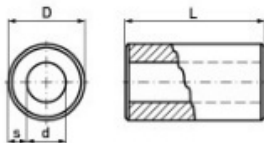

## Distanzhülsen Messing Fortsetzung

Für Schraube	M 4	M 5	M 6	M 10
	∅ D = 8,0 ∅ d = 4,3 s = 1,85	∅ D = 10,0 ∅ d = 5,4 s = 2,3	∅ D = 11,0 ∅ d = 6,4 s = 2,3	∅ D = 13,0 ∅ d = 10,2 s = 1,4
L	Bestell-Nr			
1,0	5.54.013	5.55.013	5.56.013	
1,5				
2,0	5.54.023	5.55.023		62.71.102
3,0	5.54.033	5.55.033	5.56.033	62.71.103
4,0	5.54.043		5.56.043	62.71.104
5,0	5.54.053	5.55.053	5.56.053	
6,0	5.54.063	5.55.063		62.71.106
7,0	5.54.073	5.55.073	5.56.073	
8,0	5.54.083	5.55.083	5.56.083	62.71.108
9,0	5.54.093	5.55.093	5.56.093	
10,0	5.54.103	5.55.103	5.56.103	62.71.110
11,0		5.55.113		
12,0	5.54.123	5.55.123	5.56.123	
14,0	5.54.143	5.55.143		
15,0	5.54.153	5.55.153	5.56.153	
16,0	5.54.163	5.55.163	5.56.163	
17,0	5.54.173	5.55.173	5.56.173	
17,5				
18,0	5.54.183	5.55.183	5.56.183	
19,0	5.54.193		5.56.193	
20,0	5.54.203	5.55.203	5.56.203	
22,0			5.56.223	
25,0	5.54.253	5.55.253	5.56.253	
27,0		5.55.273		
30,0	5.54.303	5.55.303	5.56.303	
35,0	5.54.353	5.55.353	5.56.353	
40,0	5.54.403	5.55.403	5.56.403	
45,0			5.56.453	
50,0	5.54.503	5.55.503	5.56.503	
60,0	5.54.603			

Unser Programm an Distanzhülsen wird ständig erweitert.  
Bitte fragen Sie nach einer speziellen Lösung für Ihre Anwendung!

## Distanzhülsen Aluminium

### Material:

Aluminium AlCu6BiPb Werkstoff-Nr. 3.1655 / EN AW-2011

### Fertigungstoleranzen

Allgemeintoleranzen nach DIN ISO 2768-1:1999-11 (ehem. DIN 7168-1)  
Toleranzklasse m (mittel)



Für Schraube	M 2	M 2,5	M 3	M 4	M 4	M 5
	D = 4,0 d = 2,4 s = 0,8	D = 4,5 d = 2,7 s = 0,9	D = 5,5 d = 3,3 s = 1,1	D = 6,0 d = 4,2 s = 0,9	D = 7,0 d = 4,2 s = 1,4	D = 8,0 d = 5,2 s = 1,4
L	Bestell-Nr.					
1,0	5.71.018		5.73.018			
1,5			5.73.015	5.74.015		
2,0	5.71.028	5.72.028	5.73.028		5.74.028	
2,5		5.72.025	5.73.025	5.74.025		
3,0	5.71.038	5.72.038	5.73.038	5.74.033	5.74.038	5.75.038
3,5		5.72.035	5.73.039 <sup>1)</sup>	5.74.039		
4,0	5.71.048	5.72.048	5.73.048		5.74.048	5.75.048
4,5		5.72.045		5.74.049		
5,0	5.71.058	5.72.058	5.73.058	5.74.059	5.74.058	5.75.058
5,5			5.73.055			
6,0	5.71.068	5.72.068	5.73.068	5.74.069	5.74.068	5.75.068
6,5	5.71.065	5.72.065	5.73.065		5.74.065	5.75.065
7,0		5.72.078	5.73.078		5.74.078	5.75.078
7,5			5.73.075	5.74.075		
8,0	5.71.088	5.72.088	5.73.088	5.74.089	5.74.088	
8,5		5.72.085				
9,0	5.71.098	5.72.098	5.73.098	5.74.099	5.74.098	
10,0	5.71.108	5.72.108	5.73.108		5.74.108	5.75.108
11,0		5.72.118	5.73.118	5.74.119	5.74.118	
12,0	5.71.128	5.72.128	5.73.128	5.74.129	5.74.128	
12,5			5.73.125		5.74.138	
13,0			5.73.138			
14,0		5.72.148	5.73.148	5.74.149	5.74.148	5.75.148
15,0	5.71.158	5.72.158	5.73.158	5.74.159	5.74.158	
16,0		5.72.168	5.73.168		5.74.168	
16,5					5.74.165	
17,0				5.74.179	5.74.178	
18,0				5.74.186		
18,0			5.73.188	5.74.187 <sup>2)</sup>	5.74.188	
19,0			5.73.198	5.74.199		
20,0	5.71.208	5.72.208	5.73.208	5.74.209	5.74.208	
22,0					5.74.228	
24,0			5.73.248			
25,0			5.73.258		5.74.258	
26,0			5.73.268			
28,0						5.75.288
30,0	5.71.308		5.73.308		5.74.308	5.75.308
32,0						5.75.328
40,0			5.73.408			
50,0			5.73.508			

