

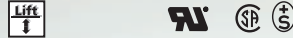

Type 71

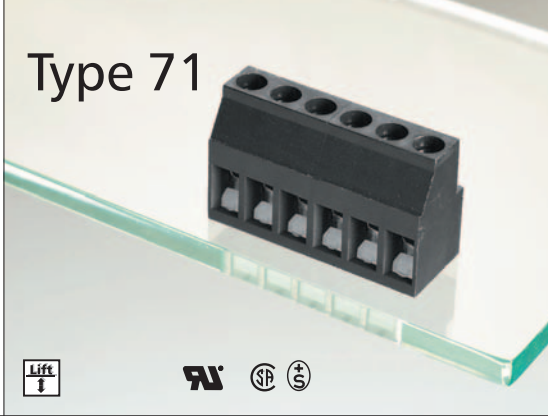

Type 72

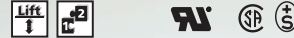
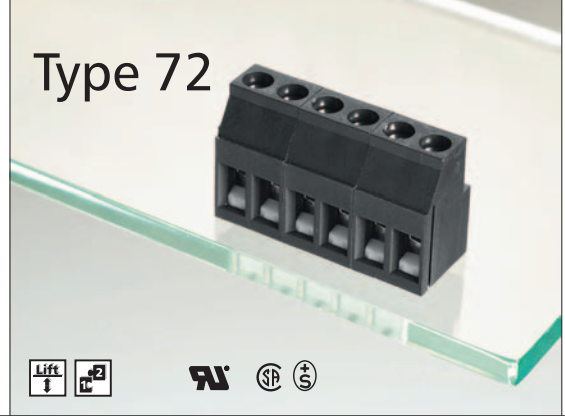

Note for wire range

Additional wire sizes and/or combinations of same size wires as follows:

Type 71 and Type 72

- ## 2 No. 22 - 16 AWG (field-wiring);
- 2 No. 30 - 16 AWG or
- 1 No. 30 - 12 AWG (factory-wiring)

Description Type 71

Screw type terminal block, solderable, centerline 5 mm / 0.197 inches, horizontal wire entry, lift system

Technical Data Type 71

UL V / A / AWG 300 / 20 / 22 - 12 ## (see note)

SP V / A / AWG 300 / 20 / 22 - 12 ## (see note)

Screw torque max. 6 lbs.-in

- CE 0.08 - 2.5 mm² 250 V / 4 kV / 3 / 16 A
Insulation co-ordination according to IEC 664-1
Clearance and creepage distance ≥ 4 mm
Screw torque max. 0.5 Nm

Wire diameter	single wire 0.3 - 2.7 mm
Wire strip length	8 mm / 0.315 in.
Solder pin	0.8 x 1 mm 0.031 x 0.039 in. recommended pc board hole dia. 1.4 mm / 0.055 in.
Solder pin length	4.1 mm / 0.161 in.
Pole size	2 to 24
Color	black

Dimensions in mm 1 mm = 0.0394 in.

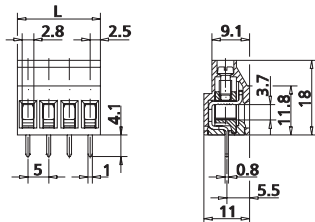

$L = (\text{pole size} - 1) \times \text{centerline} + 5 \text{ mm} / 0.197 \text{ in.}$

Description Type 72

Screw type terminal block, solderable, centerline 5 mm / 0.197 inches, horizontal wire entry, lift system, modular

Technical Data Type 72

UL V / A / AWG 300 / 20 / 22 - 12 ## (see note)

SP V / A / AWG 300 / 20 / 22 - 12 ## (see note)

Screw torque max. 6 lbs.-in

- CE 0.08 - 2.5 mm² 250 V / 4 kV / 3 / 16 A
Insulation co-ordination according to IEC 664-1
Clearance and creepage distance ≥ 4 mm
Screw torque max. 0.5 Nm

Wire diameter	single wire 0.3 - 2.7 mm
Wire strip length	8 mm / 0.315 in.
Solder pin	0.8 x 1 mm 0.031 x 0.039 in. recommended pc board hole dia. 1.4 mm / 0.055 in.
Solder pin length	4.1 mm / 0.161 in.
Pole size	2 to 4
Color	black

Dimensions in mm 1 mm = 0.0394 in.

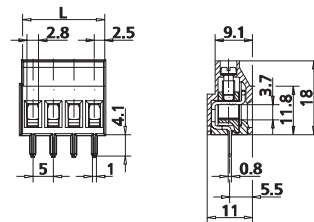

$L = (\text{pole size} - 1) \times \text{centerline} + 5 \text{ mm} / 0.197 \text{ in.}$

Part numbers (P/N)

Type 71

centerline 5 mm / 0.197 inches

P/N 310711

Complete the part number by adding the pole size.

	02	03	04	05	06	07	08
09	10	11	12	13	14	15	16
17	18	19	20	21	22	23	24

Type 71

centerline 10 mm / 0.394 inches

P/N 310712

	02	03	04	05	06	07	08
09	10	11	12				

- 02 Standard pole sizes
- 13 Available on demand. Minimum order quantity 5000 poles per item.

Part numbers (P/N)

Type 72

centerline 5 mm / 0.197 inches

P/N 310721

Complete the part number by adding the pole size.

	02	03	04				

- 02 Standard pole sizes
- Available on demand. Minimum order quantity 5000 poles per item.