

# Illuminated Navimec™

## Technical Data

- through-hole or SMD
- 50mA/24VDC
- single pole/momentary
- 10.000.000 operations life time
- IP67 sealing
- temperature range:  
LED: -30/+85°C

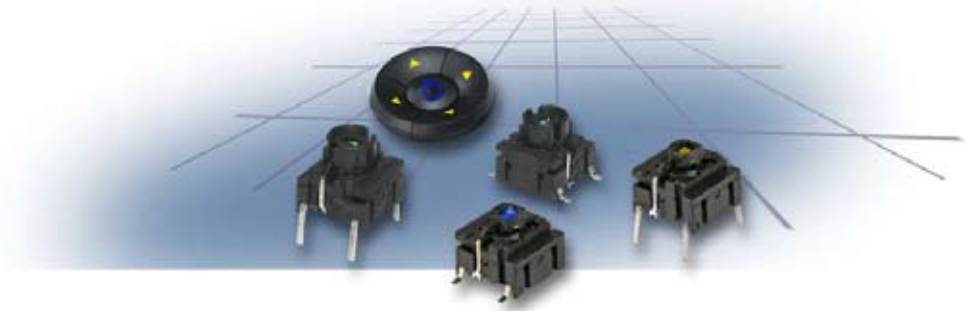

### Dimensions 1ZB (through-hole)

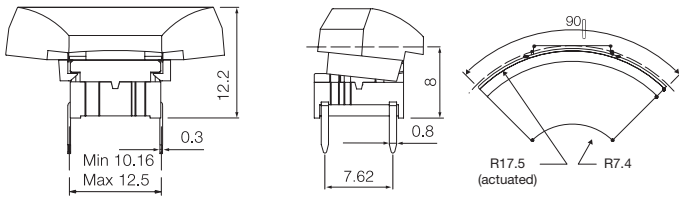

#### Top View

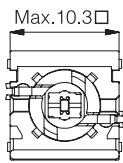

#### PCB layout and Circuit Diagram

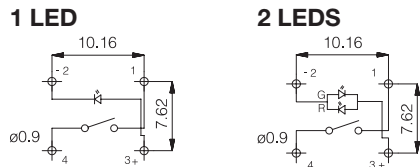

### Dimensions 1ZC (SMD)

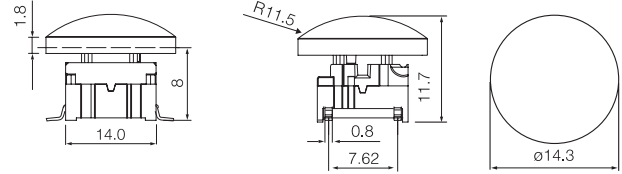

#### Top View

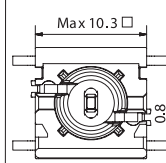

#### PCB layout and Circuit Diagram

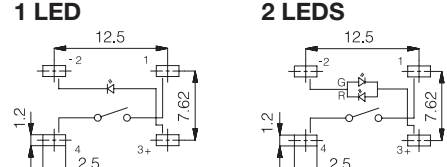

### How to order



**Switch** **Mounting**  
**SH9** surface mount  
**TH9** through-hole

**LED**  
**01**  
**22**  
**42**  
**61**  
**82**  
**2242**  
**8222**  
**8242**



**Illuminated Cap**  
**1ZB 16**



**Switch** **Mounting**  
**SH9** surface mount  
**TH9** through-hole

**LED**  
**01**  
**22**  
**42**  
**61**  
**82**  
**2242**  
**8222**  
**8242**



**Illuminated Cap**  
**1ZC 16**

### Recommended panel cut-out:

ø35.0-35.5 Depending on application

### Design example

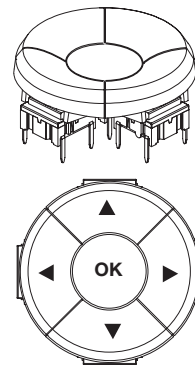

Consisting of:  
 4x4ATH9XXXX + 4x 1ZB16  
 and  
 1x4FTH9XXXX + 1x 1ZC16  
 (4F in centre position)

### Navimec™ Legends

**Part No. 1ZB16LM136** ▲  
**Part No. 1ZC16LM123** Ⓢ  
**Part No. 1ZC16LM118** OK  
**Part No. 1ZC16LM105** ENTER

Keycaps shown on this page can also be used on multimec® switches 3A and 3F

**Ordering example:** 4x4ATH901 + 1ZB16LM136 and 1x4FTH982 + 1ZC16LM118

For updates of products and/or changes of specifications please see [www.mec.dk](http://www.mec.dk)