

2218T(PC0026)

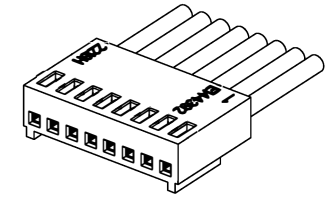
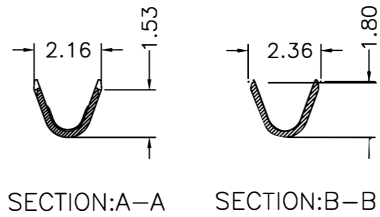

Specifications:

Current Rating:3.0A AC,DC  
 Voltage Rating:250V AC,DC  
 Contact Resistance:20mohm Max  
 Insulation Resistance:1000Mohm Min.  
 Withstanding Voltage:1000V AC/minute  
 Operating Temperature Range:-40°C~+105°C  
 Material and Finish:  
 Insulator:Nylon 66 (UL94V-0)  
 Insulator Color:Beige  
 Contact:Brass  
 Plating:Tin Plated

How To Order

2218H-XX

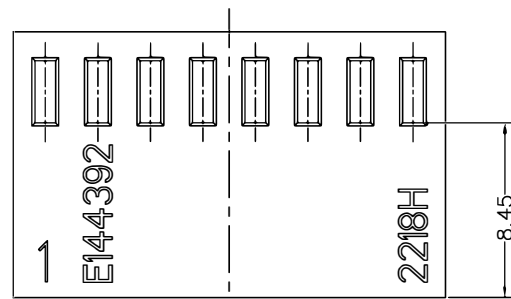
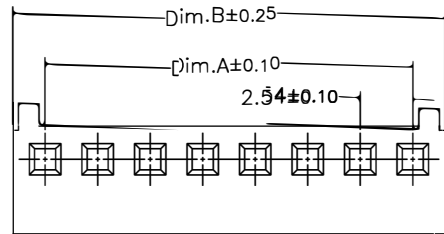
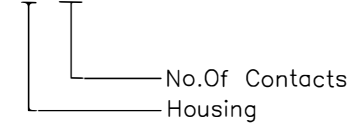

2218H-XX

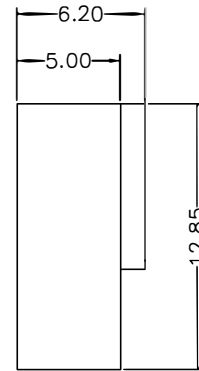

Dimension:

Circuits	Dimension:		Circuits	Dimension:	
	A	B		A	B
01		3.10	11	25.40	28.50
02	2.54	5.60	12	27.94	31.00
03	5.08	8.10	13	30.48	33.50
04	7.62	10.70	14	33.02	36.10
05	10.16	13.20	15	35.56	38.60
06	12.70	15.80	16	38.10	41.20
07	15.24	18.30	17	40.64	43.70
08	17.78	20.90	18	43.18	46.20
09	20.32	23.40	19	45.72	48.80
10	22.86	25.90	20	48.26	51.30

RoHS Compliant

				DRAWN: Henry Tang	GENERAL TOLERANCE: .X=±0.2 .XX=±0.15		
				CHECKED: Jeremy Liu	UNIT: MM	DESCRIPTION: 2.54mm Wire to Board Housing	SIZE
				APPROVAL: Mike Wu	SCALE:1:1	PART NO: 2218H-XX	<b>A4</b>
REV	DATE	FILE	BY		PROJECTION:		
A	28-Sep-2006	(PC0001)	Henry Tang				