

THIS DOCUMENT IS THE PROPERTY OF  
KEYSTONE ELECTRONICS CORP. AND  
SHALL NOT BE REPRODUCED, DISTRIBUTED  
OR USED AS A BASIS FOR MANUFACTURE  
WITHOUT PRIOR WRITTEN PERMISSION  
FROM KEYSTONE ELECTRONICS CORP.

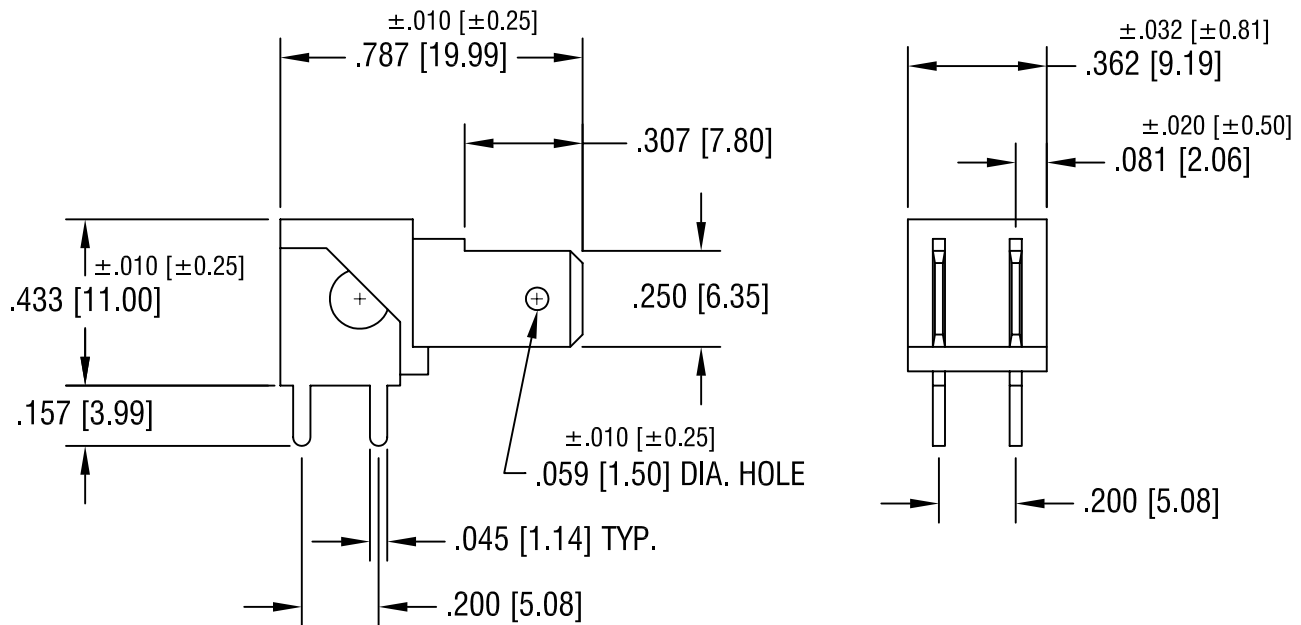

NOTES:

1. TABS:  
MAT'L -  $.032$  [ $0.81$ ] TH'K BRASS  
FINISH - TIN PLATE
2. INSULATOR:  
MAT'L - POLYCARBONATE
3. MOUNTING HOLES:  
 $.052$  [ $1.32$ ] DIA. x  
 $.200$  [ $5.08$ ] CENTERS

**KEYSTONE ELECTRONICS CORP.**

ASTORIA, N.Y. 11105-2017

PART NAME		<b>.250 [6.35] PC QUICK-FIT HEADER</b>	
MATERIAL		AS NOTED	
FINISH	TIN PLATE	DRN BY	BOONE
		APP'D	LN
		DATE	7.24.95
		SCALE	2X
TOLERANCES	INCH [MM]	CODE	DWG NO.
DECIMAL	$\pm .005$ [ $\pm 0.15$ ]	C/M	<b>7802</b>
ANGULAR	$\pm 1^\circ$	UNLESS OTHERWISE SPECIFIED	

2.1.05	CHANGE AS PER ECN 05-005	E
DATE	DESCRIPTION	REV.